

Top 2nos 25 mm
 Bott 4nos 25 mm



Top 4nos 25 mm
 Bott 2nos 25 mm

PAN AT SUPPORT

ROOF BEAM DETAIL

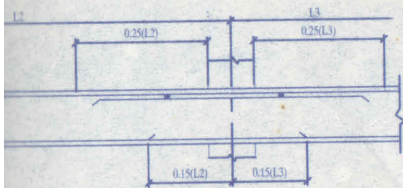

P.O. BIRNAGAR, NADIA - 741127, P.S. TAHERPUR, W.B.

BEARING CAPACITY OF SOIL ASSUMED AS 10t PER SQ.M
 AREA STATEMENT :-

	Existing	Proposed
1. GROUND FLOOR AREA	: 756.85 SQM.	119.40 SQM.
2. FIRST FLOOR AREA	: 756.85 SQM.	119.40 SQM.
3. SECOND FLOOR AREA	: 756.85 SQM.	119.40 SQM.
4. THIRD FLOOR AREA	: 756.85 SQM.	119.40 SQM.
TOTAL	: 3027.40 SQM. +	477.60 SQM.
	= 3505.00 SQM.	

NAME OF OWNER :-

**BIRNAGAR
 KABI NABIN CHANDRA SEN
 TEACHERS TRAINING INSTITUTE**

AUTHORIZED SIGNATORY

[Signature] 28/8/16
 President
 Birnagar Kabi Nabin Chandra Sen
 Teachers' Training Institute
 Nazirpur, Birnagar, Nadia

[Signature] 28/8/16
 Secretary
 Birnagar Kabi Nabin Chandra Sen
 Teachers' Training Institute
 Nazirpur, Birnagar, Nadia

[Signature] 31/05/16
 Prodhan
 Barasat G.P.
 Barasat, Bhaduri, Nadia

[Signature]
 Supriya Sarkar
 B.Tech (Civil), MBA (Constr. Mgmt.)
 Member of IGBC (IGBC-IM-1100046)
 Member of IAENCG (180564)
 L.B.S of TNAI (01/LBS/IA)
 Krishnagar, Nadia. 24/1/2016

[Signature]
 Assistant Engineer
 Behampore Division
 M.E.Dc., M.A. Deptt.
 Govt. of West Bengal
 29/05/16

DRN BY
 SCALE 1:100

CKD BY
 SHEET NO. 1 OF 1